

VERSA-LOK NEXUS

RETAINING WALL SYSTEM

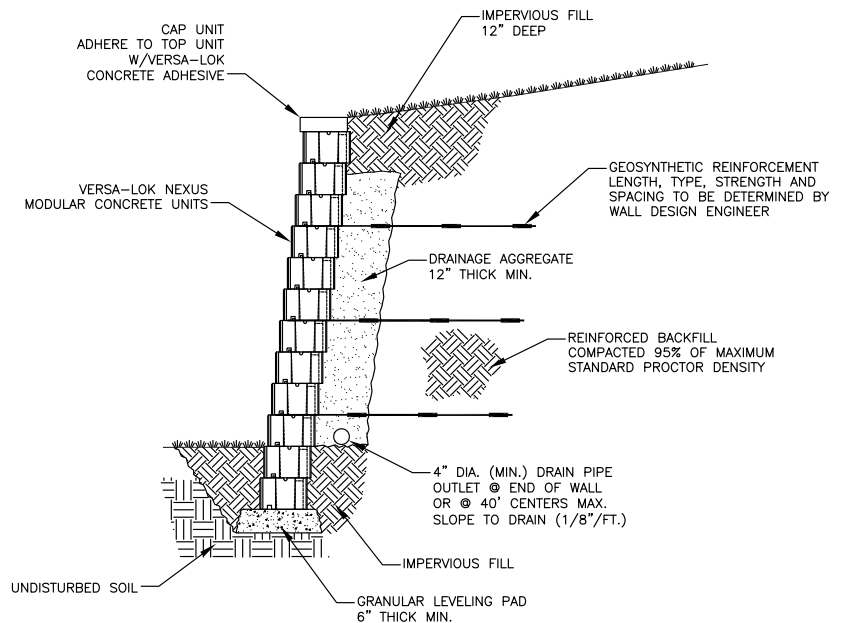

Typical Section Reinforced Retaining Wall



Nexus Unit Specifications	
Height	8"
Depth	12"
Width	18"
Face Area	1 S.F.
Weight	82 LBS.
Weight (with aggregate fill)	115 LBS.
Setback	1"
Batter / Cant	7 degrees
Interlock	top studs
Min. Radius	7' (4.5', half bond)
Max. Unreinforced Height	3'
Max. Geogrid Reinforced Height	Unlimited

When you need to retain a lot of ground economically, the VERSA-LOK Nexus® retaining wall system can meet your project's design specs and budget and create a great-looking retaining wall for your client. Nexus units are engineered to provide the construction flexibility you need in a large retaining wall project. Each 82-pound unit covers a full square foot of wall space affordably and attractively. The Nexus wall system is a smart choice for large public works, institutional and commercial projects.

The top-stud design readily accommodates variable bond, so you can create walls that have a more natural appearance. On half-bond, the top access slots of the units align horizontally and the center cores align vertically. This allows materials, like concrete or rebar, to be placed across or through adjacent units for custom-designed applications. The top slots, both parallel and perpendicular to the unit face, also can accommodate custom-made connectors. Finish off your Nexus wall with matching VERSA-LOK cap units.